

PROGRAMS & SERVICES

Community-Based Outreach & Advocacy Programs (CBOA)

O'ahu & Kaua'i - 808.589.1829 Ext. 200

Emergency Shelters (ES) / Kamala Homes (KH)

O'ahu - 808.754.9844

Guide On The Side (GOTS)

O'ahu - 808.265.0635

Hale Lanipōlua Assessment Center (HLAC)

O'ahu - 808.266.7980

Hāloa House

O'ahu - 808.589.1829 Ext. 233

Ho'okala Attendant Care Program

O'ahu - 808.589.1829 Ext. 160

Housing First

O'ahu - 808.589.1829 Ext. 200

Independent Living Programs (ILP) / Imua Kākou (IK)

O'ahu - 808.589.1829 Ext. 233

Independent Living Program Training Home (ILPTH)

O'ahu - 808.589.1829 Ext. 200

Intensive In-Home Services (IIH) /

Intensive Independent Living Skills (IILS)

O'ahu - 808.589.1829 Ext. 400

Kaua'i - 808.589.1829 Ext. 200 • Hawai'i - 808.969.1935

Ka'i Like Program

O'ahu - 808.589.1829 Ext. 200 • Hawai'i - 808.969.1935

Kalihi Juvenile Assessment Center (KJAC)

O'ahu - 808.336.1573

'Ohana Resilience Services (ORS) at Hale Kū Ola

O'ahu - 808.589.1829 Ext. 600

Step-Up Housing & Foster Youth to Independence (FYI)

O'ahu - 808.589.1829 Ext. 233

Trafficking Victim Assistance Program (TVAP)

Hotline - 1.888.398.1188 (O'ahu, Kaua'i, Hawai'i)

Transition & Aftercare Support Services (TASS)

O'ahu & Kaua'i - 808.589.1829 Ext. 200

Hawai'i & Maui - 808.969.1935

Transitional Family Homes (TFH)

O'ahu - 808.589.1829 Ext. 400 • Hawai'i - 808.969.1935

Transitional Living Program (TLP)

O'ahu - 808.589.1829 Ext. 200

Wraparound Services

O'ahu - 808.589.1829 Ext. 200 • Hawai'i - 808.854.9032

Youth Outreach (YO!)

O'ahu - 808.942.5858

MISSION STATEMENT

Hale Kipa provides opportunities and environments that strengthen and encourage youth, their families and communities to actualize their potential and social responsibility.

Hale Kipa is a multi-service, fully accredited 501(c)(3) nonprofit agency that specializes in working with youth and their families who often have nowhere else to turn. Hale Kipa has served more than 74,000 youth throughout Hawai'i since its beginning in 1970 as a single shelter on O'ahu.

This includes working in partnership with public agencies and private organizations to provide residential, outreach, and foster care services at no cost. With programs that are flexible and responsive to changing needs, Hale Kipa supports youth involved in juvenile justice, behavioral health, education and child welfare. Program goals include stabilizing young people in crisis and helping youth and families build resiliency to experience success in their lives. Services are flexible, free, creative, and determined by the youth's and family's needs.

All persons are treated equitably and without favoritism, subject to limitations imposed by contractual obligations.



HALE KIPA

91-2128 Old Fort Weaver Road • 'Ewa Beach, HI 96706

T 808.589.1829 • F 808.589.2610

info@halekipa.org • www.halekipa.org



Aloha United Way
Kauai United Way
Hawaii Island United Way



HALE KIPA

Empowering Lives - One Youth At A Time



Transitional Living Program (TLP)

Since 1999 Hale Kipa's Transitional Living Program on O'ahu has been providing residential services to young adults ages 18 through 21 experiencing being unsheltered to promote their successful transition to self-sufficiency.

Transitional Living Program Residences:

- Our **Men's Residence** houses four men at a time, ages 18 through 21.
- Our **Women's Residence** houses four women at a time, ages 18 through 21 (single, pregnant and/or parenting), and up to two babies.

In the program, young adults work toward educational and vocational goals and learn life skills as they transition out of being unsheltered. It is our commitment to honor their strengths and support them in realizing their goals while providing appropriate structure and support.

Population and Eligibility Criteria

- Young adults ages 18 through 21
- Homeless or at imminent risk of becoming unsheltered
- Willing to participate in program
- Desire to make changes to better one's situation

Young Adult Responsibilities

- Participate in program activities
- Desire to make changes

Services

- Goal Planning
- Case Management
- Skill Building
- Employment Assistance
- Housing Assistance
- Advocacy
- Information and Referral
- Financial Assistance for rent/deposit
- Transitional Planning

Discharge Criteria

- Achieve maximum stay of 18 months
- Young adult ages out (a young adult may enter at the maximum age of 21 and age out at 22 years and six months)
- Young adult successfully completes program goals
- Young adult voluntarily leaves program
- Young adult needs services beyond what the agency can provide
- Young adult is terminated from program for gross violation of rules
- Program loses contact with young adult; whereabouts unknown

Contact Information

O'ahu – 808.284.2079



Guiding Principles

- *Sanctuary / Safety*
- *Nurturance*
- *Pride / Trust*
- *Sense of Belonging / Community ('Ohana)*
- *Empowerment*
- *Importance of Choice*
- *Inherent Worth of the Individual*
- *Responsibility and Accountability for one's own, as well as each other's successes and "failures"*

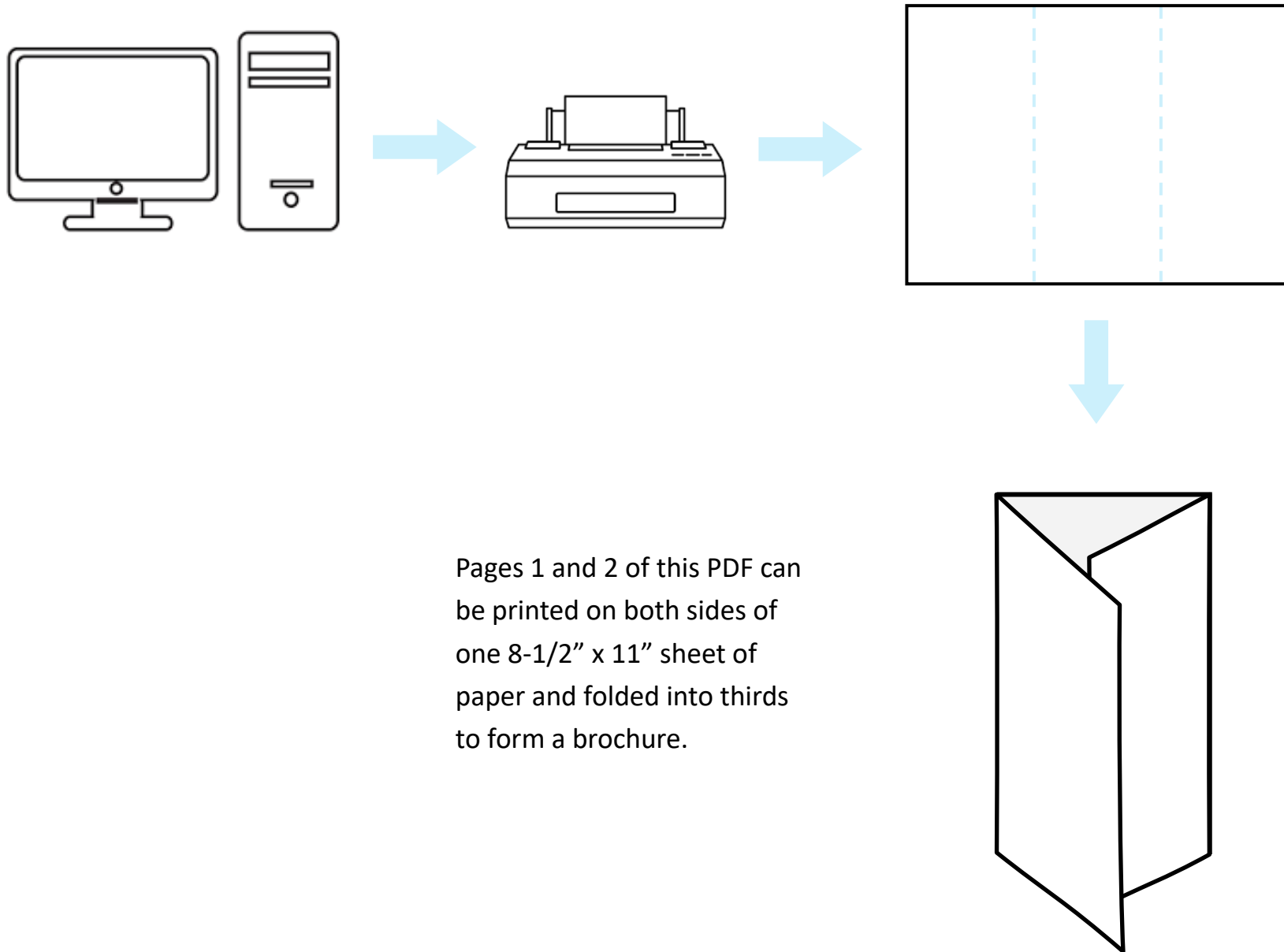

Pages 1 and 2 of this PDF can be printed on both sides of one 8-1/2" x 11" sheet of paper and folded into thirds to form a brochure.