

## PROGRAMS & SERVICES

### Community-Based Outreach & Advocacy Programs (CBOA)

O'ahu & Kaua'i - 808.589.1829 Ext. 200

### Emergency Shelters (ES) / Kamala Homes (KH)

O'ahu - 808.754.9844

### Guide On The Side (GOTS)

O'ahu - 808.265.0635

### Hale Ho'opakele

O'ahu - 808.589.1829 Ext. 111

### Hāloa House

O'ahu - 808.589.1829 Ext. 233

### Ho'okala Attendant Care Program

O'ahu - 808.589.1829 Ext. 160

### Housing First

O'ahu - 808.589.1829 Ext. 200

### Independent Living Programs (ILP) / Imua Kākou (IK)

O'ahu - 808.589.1829 Ext. 233

### Independent Living Program Training Home (ILPTH)

O'ahu - 808.589.1829 Ext. 200

### Intensive In-Home Services (IIH) /

### Intensive Independent Living Skills (IILS)

O'ahu - 808.589.1829 Ext. 400

Kaua'i - 808.589.1829 Ext. 200 • Hawai'i - 808.969.1935

### Ka'i Like Program

O'ahu - 808.589.1829 Ext. 200 • Hawai'i - 808.969.1935

### Kalihi Juvenile Assessment Center (KJAC)

O'ahu - 808.336.1573

### 'Ohana Resilience Services (ORS) at Hale Kū Ola

O'ahu - 808.589.1829 Ext. 600

### Step-Up Housing & Foster Youth to Independence (FYI)

O'ahu - 808.589.1829 Ext. 233

### Trafficking Victim Assistance Program (TVAP)

Hotline - 1.888.398.1188 (O'ahu, Kaua'i, Hawai'i)

### Transition & Aftercare Support Services (TASS)

O'ahu & Kaua'i - 808.589.1829 Ext. 200

Hawai'i & Maui - 808.969.1935

### Transitional Family Homes (TFH)

O'ahu - 808.589.1829 Ext. 400 • Hawai'i - 808.969.1935

### Transitional Living Program (TLP)

O'ahu - 808.589.1829 Ext. 200

### Wraparound Services

O'ahu - 808.589.1829 Ext. 200 • Hawai'i - 808.854.9032

### Youth Outreach (YO!)

O'ahu - 808.942.5858

## MISSION STATEMENT

*Hale Kipa provides opportunities and environments that strengthen and encourage youth, their families and communities to actualize their potential and social responsibility.*

Hale Kipa is a multi-service, fully accredited 501(c)(3) nonprofit agency that specializes in working with youth and their families who often have nowhere else to turn. Hale Kipa has served more than 74,000 youth throughout Hawai'i since its beginning in 1970 as a single shelter on O'ahu.

This includes working in partnership with public agencies and private organizations to provide residential, outreach, and foster care services at no cost. With programs that are flexible and responsive to changing needs, Hale Kipa supports youth involved in juvenile justice, behavioral health, education and child welfare. Program goals include stabilizing young people in crisis and helping youth and families build resiliency to experience success in their lives. Services are flexible, free, creative, and determined by the youth's and family's needs.

All persons are treated equitably and without favoritism, subject to limitations imposed by contractual obligations.



# HALE KIPA

91-2128 Old Fort Weaver Road • 'Ewa Beach, HI 96706

T 808.589.1829 • F 808.589.2610

info@halekipa.org • www.halekipa.org



Aloha United Way  
Kauai United Way  
Hawaii Island United Way



# Step-Up Housing & Foster Youth to Independence Programs

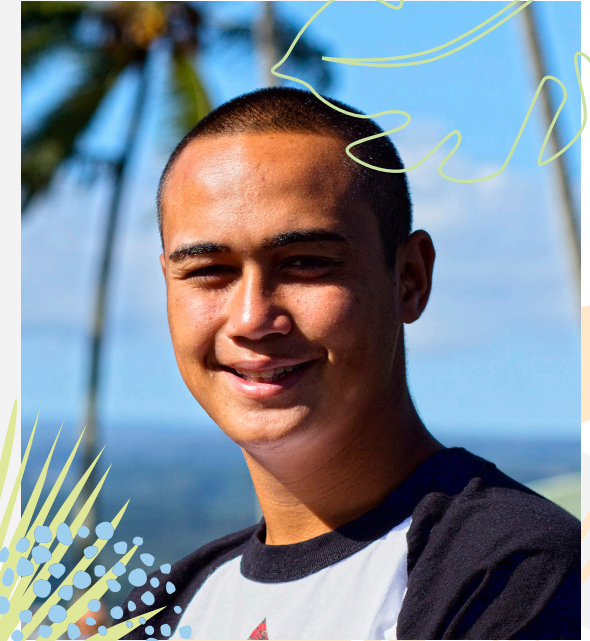

# HALE KIPA

Empowering Lives - One Youth At A Time

## Step-Up Housing Program

Hale Kipa's Step-Up Housing Program on O'ahu allows young adults a choice in their selection of a decent, safe and affordable home on their journey to self-sufficiency.

Under the Family Unification Program, Step-Up Housing provides Housing Choice Vouchers to young adults aging out of foster care. Housing assistance through Section 8 is awarded to young adults for a maximum of 36 months. A voucher allows the participants to rent a home in the community of their choice. Participants initially pay between 30% and 40% of their monthly adjusted income toward rent and utilities, with the balance paid through Section 8.

Young adults can enroll in the program through self-referral or be referred by Hale Kipa, Child Welfare System, or Youth Circles.

## Population and Eligibility Criteria

- In foster care after the age of 16
- Currently age 18 through 24
- Have a stable source of income
- Can be married and/or have dependents
- Currently lack adequate housing
- Meet the Public Housing Authority / Department of Community Services (DCS) / Section 8 eligibility criteria

## Section 8

- The Section 8 eligibility process includes a background check. The following will prevent an applicant from being eligible:
- Record of violent criminal activity
- Record of sex offenses
- Fraud of or previous eviction from federal housing
- Alcohol/drug abuse
- Distribution/production of drugs

Section 8 will alert the Hale Kipa Case Manager if the young adult is determined eligible to schedule an interview and finalize eligibility

## Young Adult Responsibilities

- Participate in program activities
- Compile personal documents and attend a preliminary interview with a Section 8 examiner to determine eligibility
- If eligible, attend Section 8 briefing to receive voucher
- Locate and rent housing
- Attend monthly meeting with case manager
- Complete annual recertification requirements including an annual inspection

## Services

- Develop Transitional Plan with young adult
- Assist with Section 8 applications
- Prepare young adult for Section 8 interview process
- Linkages and collaboration with other community resources
- 24-hour staff accessibility

## Foster Youth to Independence (FYI)

The Foster Youth to Independence (FYI) initiative makes Housing Choice Voucher (HCV) assistance available to Public Housing Agencies (PHAs) in partnership with Public Child Welfare Agencies (PCWAs). Under FYI PHAs provide housing assistance on behalf of:

Youth at least 18 years and not more than 24 years of age (have not reached their 25th birthday) who left foster care, or will leave foster care within 90 days, in accordance with a transition plan described in Section 475(5)(H) of the Social Security Act, and are homeless or are at risk of becoming homeless at age 16 or older.

As required by statute, an FYI Competitive voucher issued to such a youth may only be used to provide housing assistance for the youth for a maximum of 36 months.

In addition to providing up to 36 months of rental assistance, youth must be provided supportive services to assist the young person on their path to self-sufficiency.

## Contact Information

O'ahu – 808.589.1829, Ext. 233

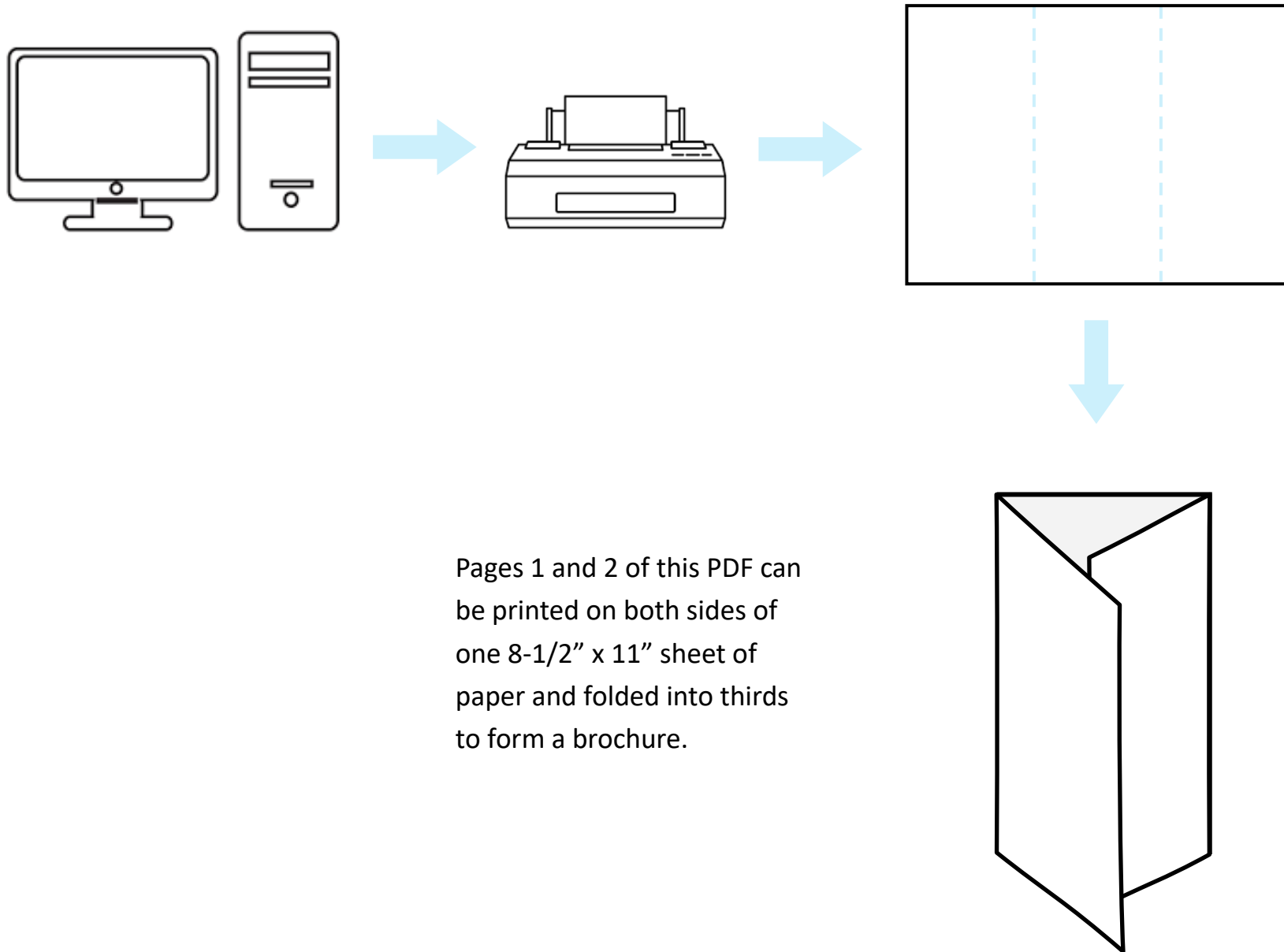

Pages 1 and 2 of this PDF can be printed on both sides of one 8-1/2" x 11" sheet of paper and folded into thirds to form a brochure.