

## PROGRAMS & SERVICES

### Community-Based Outreach & Advocacy Programs (CBOA)

O'ahu & Kaua'i - 808.589.1829 Ext. 200

### Emergency Shelters / Kamala Homes

O'ahu - 808.754.9844

### Guide On The Side (GOTS)

O'ahu - 808.265.0635

### Hale Lanipōlua Assessment Center (HLAC)

O'ahu - 808.266.7980

### Hāloa House

O'ahu - 808.589.1829 Ext. 233

### Ho'okala Attendant Care Program

O'ahu - 808.589.1829 Ext. 160

### Housing First

O'ahu - 808.589.1829 Ext. 200

### Independent Living Programs (ILP) / Imua Kākou (IK)

O'ahu - 808.589.1829 Ext. 233

### Independent Living Program Training Home (ILPTH)

O'ahu - 808.589.1829 Ext. 200

### Intensive In-Home Services (IIHS) /

### Intensive Independent Living Skills (IILS)

O'ahu - 808.589.1829 Ext. 400

Kaua'i - 808.589.1829 Ext. 200 • Hawai'i - 808.969.1935

### Ka'i Like Program

O'ahu - 808.589.1829 Ext. 200 • Hawai'i - 808.969.1935

### Kalihi Juvenile Assessment Center (KJAC)

O'ahu - 808.336.1573

### School Success Program (SSP)

Kaua'i - 808.589.1829 Ext. 200

### Step-Up Housing & Foster Youth to Independence (FYI)

O'ahu - 808.589.1829 Ext. 233

### Trafficking Victim Assistance Program (TVAP)

Hotline - 1.888.398.1188 (O'ahu, Kaua'i, Hawai'i)

### Transition & Aftercare Support Services (TASS)

O'ahu & Kaua'i - 808.589.1829 Ext. 200

Hawai'i & Maui - 808.969.1935

### Transitional Family Homes (TFH)

O'ahu - 808.589.1829 Ext. 400 • Hawai'i - 808.969.1935

### Transitional Living Program (TLP)

O'ahu - 808.589.1829 Ext. 200

### Wraparound Services

O'ahu - 808.589.1829 Ext. 200 • Hawai'i - 808.854.9032

### Youth Outreach (YO!)

O'ahu - 808.942.5858

## MISSION STATEMENT

*Hale Kipa provides opportunities and environments that strengthen and encourage youth, their families and communities to actualize their potential and social responsibility.*

Hale Kipa, or "House of Friendliness," is a multi-service, fully accredited 501(c)(3) nonprofit agency that specializes in working with youth and their families who often have nowhere else to turn. Hale Kipa has served more than 67,000 youth throughout Hawai'i since its beginning in 1970 as a single shelter on O'ahu.

This includes working in partnership with public agencies and private organizations to provide residential, outreach, and foster care services at no cost. With programs that are flexible and responsive to changing needs, Hale Kipa supports youth involved in juvenile justice, behavioral health, education and child welfare. Program goals include stabilizing young people in crisis and helping youth and families build resiliency to experience success in their lives. Services are flexible, free, creative, and determined by the youth's and family's needs.

All persons are treated equitably and without favoritism, subject to limitations imposed by contractual obligations.



## HALE KIPA

91-2128 Old Fort Weaver Road • 'Ewa Beach, HI 96706

T 808.589.1829 • F 808.589.2610

info@halekipa.org • www.halekipa.org



Aloha United Way  
Kauai United Way  
Hawaii Island United Way



# School Success Program



## HALE KIPA

Inspiring Lives - One Youth At A Time

## School Success Program (SSP)

Hale Kipa's School Success Program is a one-on-one mentoring / tutoring / support service on Kaua'i designed to meet the educational needs of youth, and to inspire them in lifelong learning. The goal of this program is to determine the most appropriate educational path for each youth and support them in that pursuit.

Youth can enroll in the School Success Program through self-referral, by the request of Family Court, Department of Education, or another social service agency.

## Population and Eligibility Criteria

Youth who have been suspended or are at risk of being suspended, are having current educational challenges and/or who have dropped out of school.

## Hale Kipa Currently Offers

### The Following Educational Paths

#### GED / HiSET

For youth who are ready to pursue a GED or HiSET, we assist them with studying for the specific tests with the tools provided by the McKinley School for Adults. (Ages 16 through 21)

#### Work Development

Assistance with job applications and placement.

#### Credit Recovery

Assistance for students ready to make up missed school credits. We help them enroll in credit recovery through their school and offer support as they work toward their goal. (Any age)

## Services

- Education and Homework Support
- Tutoring
- Assessment
- Case Management
- Individualized Support
- Family Support
- Advocacy and Referrals
- Resource Development
- Linkages and Collaboration
- Transportation
- Activities (recreational, skill building, cultural)
- 24-hour staff Accessibility / Crisis / Emergency Interventions

## Youth and Family Responsibilities

- Participate in program
- Participate in individualized service plan
- Participate in program activities
- Attend homework and tutoring support to stay afloat academically
- Comply with school rules / conditions regarding suspension

## Contact Information

Kaua'i - 808.589.1829 Ext. 200



*"I've gotten a lot of help from this program. I'm not quite there yet, but I came a long way from where I started."*

*Kiane C.*

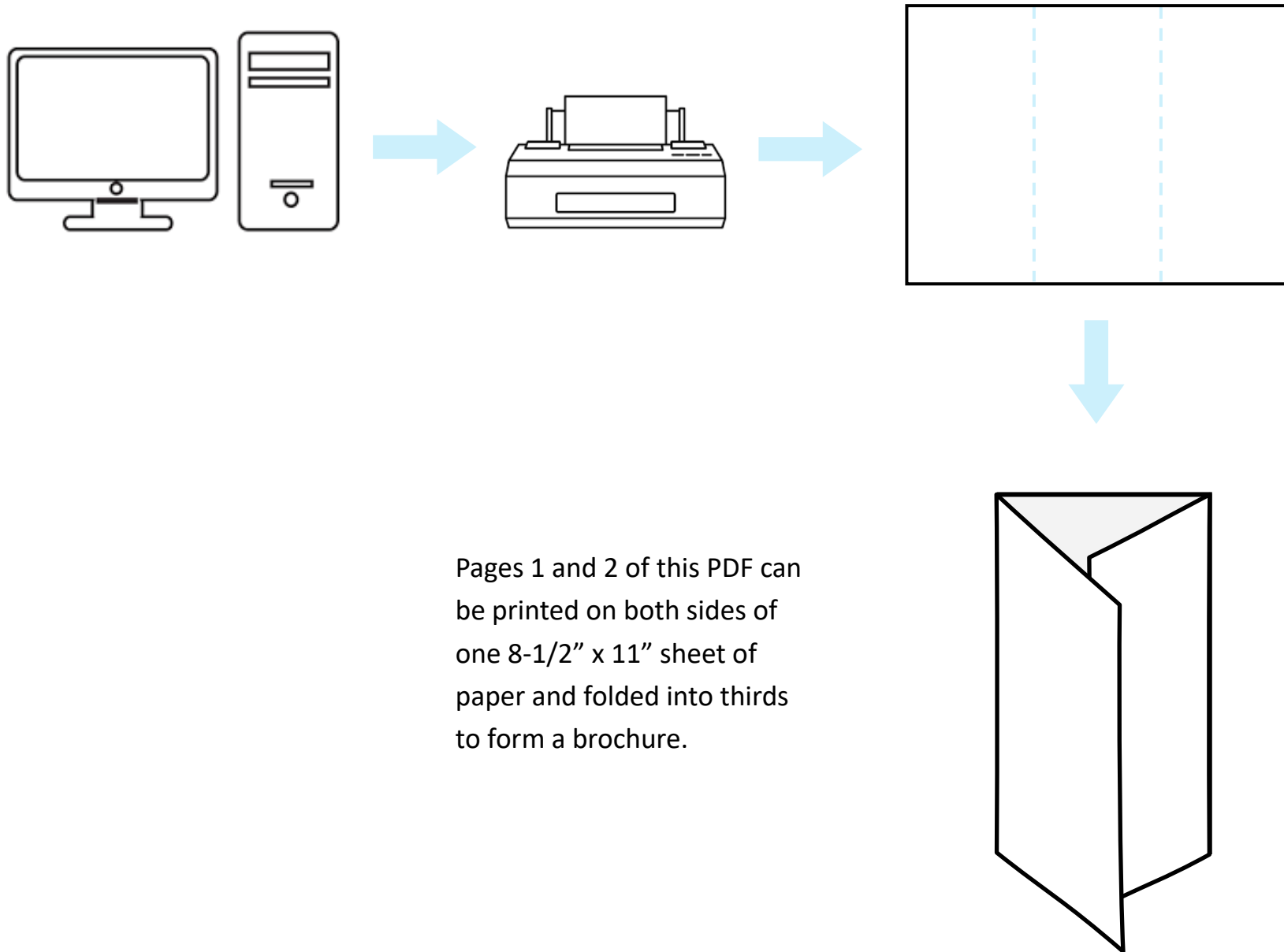

Pages 1 and 2 of this PDF can be printed on both sides of one 8-1/2" x 11" sheet of paper and folded into thirds to form a brochure.