

## PROGRAMS & SERVICES

### Community-Based Outreach & Advocacy Programs (CBOA)

O'ahu & Kaua'i - 808.589.1829 Ext. 200

### Emergency Shelters / Kamala Homes

O'ahu - 808.754.9844

### Guide On The Side (GOTS)

O'ahu - 808.265.0635

### Hale Lanipōlua Assessment Center (HLAC)

O'ahu - 808.266.7980

### Hāloa House

O'ahu - 808.589.1829 Ext. 233

### Ho'okala Attendant Care Program

O'ahu - 808.589.1829 Ext. 160

### Housing First

O'ahu - 808.589.1829 Ext. 200

### Independent Living Programs (ILP) / Imua Kākou (IK)

O'ahu - 808.589.1829 Ext. 233

### Independent Living Program Training Home (ILPTH)

O'ahu - 808.589.1829 Ext. 200

### Intensive In-Home Services (IIHS) / Intensive Independent Living Skills (IILS)

O'ahu - 808.589.1829 Ext. 400

Kaua'i - 808.589.1829 Ext. 200 • Hawai'i - 808.969.1935

### Ka'i Like Program

O'ahu - 808.589.1829 Ext. 200 • Hawai'i - 808.969.1935

### Kalihi Juvenile Assessment Center (KJAC)

O'ahu - 808.336.1573

### School Success Program (SSP)

Kaua'i - 808.589.1829 Ext. 200

### Step-Up Housing & Foster Youth to Independence (FYI)

O'ahu - 808.589.1829 Ext. 233

### Trafficking Victim Assistance Program (TVAP)

Hotline - 1.888.398.1188 (O'ahu, Kaua'i, Hawai'i)

### Transition & Aftercare Support Services (TASS)

O'ahu & Kaua'i - 808.589.1829 Ext. 200

Hawai'i & Maui - 808.969.1935

### Transitional Family Homes (TFH)

O'ahu - 808.589.1829 Ext. 400 • Hawai'i - 808.969.1935

### Transitional Living Program (TLP)

O'ahu - 808.589.1829 Ext. 200

### Wraparound Services

O'ahu - 808.589.1829 Ext. 200 • Hawai'i - 808.854.9032

### Youth Outreach (YO!)

O'ahu - 808.942.5858

## MISSION STATEMENT

*Hale Kipa provides opportunities and environments that strengthen and encourage youth, their families and communities to actualize their potential and social responsibility.*

Hale Kipa, or “House of Friendliness,” is a multi-service, fully accredited 501(c)(3) nonprofit agency that specializes in working with youth and their families who often have nowhere else to turn. Hale Kipa has served more than 67,000 youth throughout Hawai'i since its beginning in 1970 as a single shelter on O'ahu.

This includes working in partnership with public agencies and private organizations to provide residential, outreach, and foster care services at no cost. With programs that are flexible and responsive to changing needs, Hale Kipa supports youth involved in juvenile justice, behavioral health, education and child welfare. Program goals include stabilizing young people in crisis and helping youth and families build resiliency to experience success in their lives. Services are flexible, free, creative, and determined by the youth's and family's needs.

All persons are treated equitably and without favoritism, subject to limitations imposed by contractual obligations.



## HALE KIPA

91-2128 Old Fort Weaver Road • 'Ewa Beach, HI 96706

T 808.589.1829 • F 808.589.2610

info@halekipa.org • www.halekipa.org



Aloha United Way  
Kauai United Way  
Hawaii Island United Way



## HALE KIPA

Inspiring Lives - One Youth At A Time



## Transition & Aftercare Support Services (TASS)

Transition & Aftercare Support Services provides support for youth transitioning back into the community from the Hawai'i Youth Correctional Facility and their families.

Services are based on an intensive, individualized, and strengths-based approach that focuses on the youth and family's needs and goals. Each family is assigned a Community Advocate who helps them identify and cultivate community relationships and form a network to provide support. Families receive an average of 6 hours of advocacy services each week.

Some youth and families may also participate in our wraparound services, which are provided by a facilitator, navigator and parent partner.

### Population and Eligibility Criteria

- Youth ages 12 through 18 (20 if youth is on parole)
- Transitioning out of the Hawai'i Youth Correctional Facility

### Youth and Family Responsibilities:

- Participate in the development of an individualized service plan and personal goals
- Participate in program activities, at a specific number of hours per week
- Attend school or maintain another appropriate educational or vocational plan

### Services

- Individual and group support
- Advocacy and referrals
- Comprehensive assessments
- Individualized service plan development
- Competency development for youth and parents
- Youth and family support
- Resources development
- In-school assistance
- Connections and collaboration with other community resources
- Activities (recreational, skill building, cultural tutoring, etc.)
- Twenty-four-hour staff accessibility for crisis and emergency situations

### Contact Information

O'ahu & Kaua'i – 808.589.1829 Ext. 200

Hawai'i & Maui – 808.969.1935

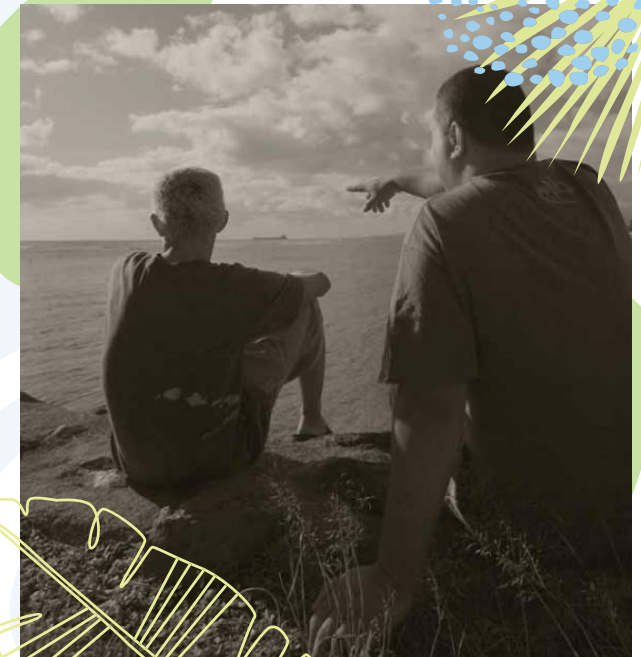

*“Hale Kipa saw a potential in me. That stuck with me all through the tough years.”*

*Jason*

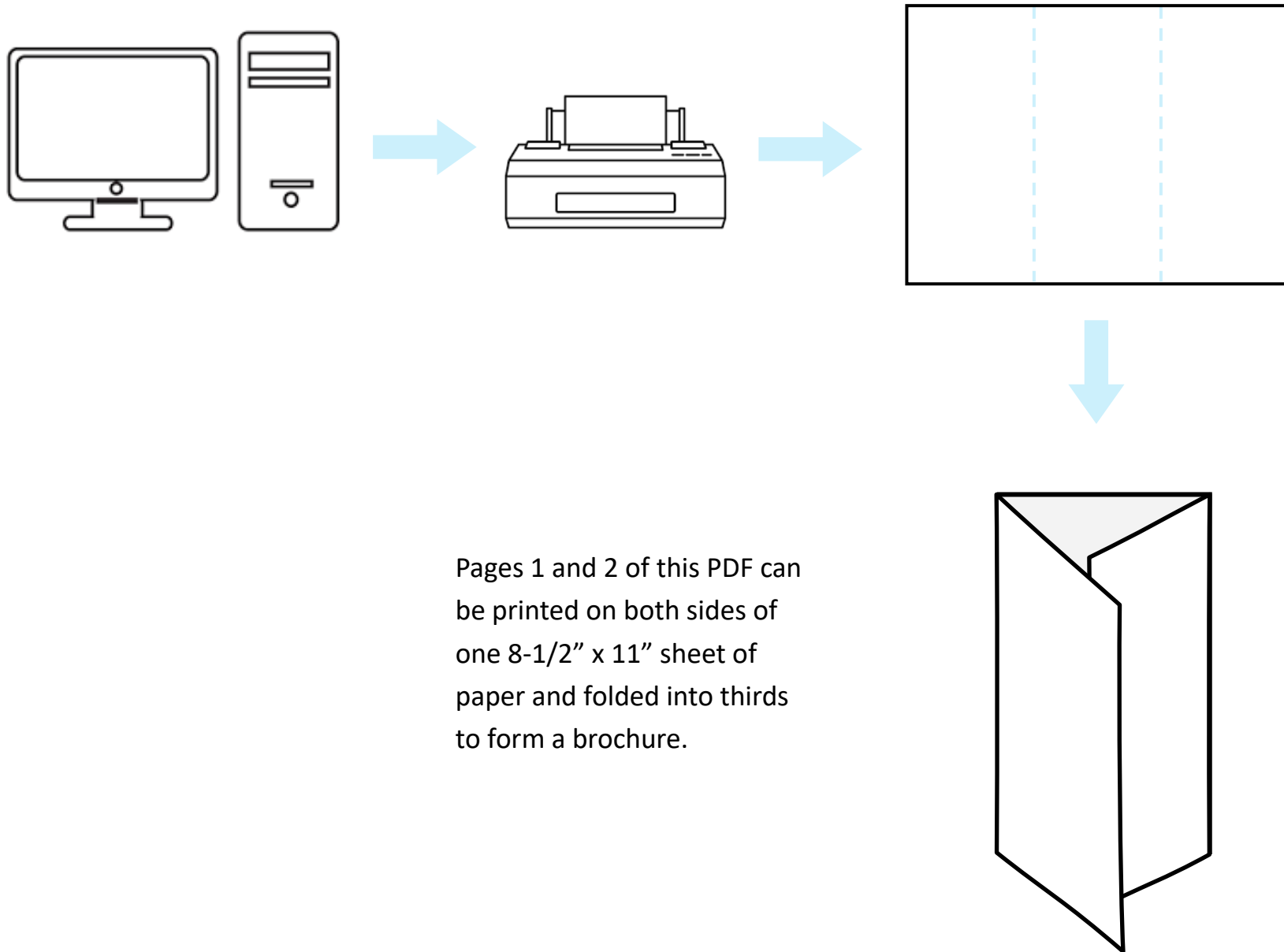

Pages 1 and 2 of this PDF can be printed on both sides of one 8-1/2" x 11" sheet of paper and folded into thirds to form a brochure.