

Hale Kipa TFH foster parents are invaluable to our island community and especially to the youth and families they serve. Foster parents often help youth learn practical skills, like cleaning their rooms and preparing dinner staples like rice.

*“The most important thing you can do is show them that you trust them.”*

*Hale Kipa TFH Foster Parent*



Hale Kipa foster parents are trained in:

- Trauma & Trauma-informed care
- Understanding Child Development
- Therapeutic Communication
- Conflict Resolution
- Developing Healthy Relationships
- Medication Management
- Technology use in the home
- First Aid & CPR
- Mental & Behavioral Health

### MISSION STATEMENT

*Rooted in aloha and kuleana, Hale Kipa is dedicated to supporting and empowering Hawai'i's youth, young adults, and families who are navigating trauma, injustice, and systemic barriers. Through safe and nurturing housing, culturally grounded care, and trauma-informed relationships, we encourage them to discover their passions, embrace their resilience, and thrive as compassionate, responsible leaders in their families and communities.*

Hale Kipa is a multi-service, fully accredited 501(c)(3) nonprofit agency that specializes in working with youth and their families who often have nowhere else to turn. Hale Kipa has served more than 74,000 youth throughout Hawai'i since its beginning in 1970 as a single shelter on O'ahu.

This includes working in partnership with public agencies and private organizations to provide residential, outreach, and foster care services at no cost. With programs that are flexible and responsive to changing needs, Hale Kipa supports youth involved in juvenile justice, behavioral health, education and child welfare. Program goals include stabilizing young people in crisis and helping youth and families build resiliency to experience success in their lives. Services are flexible, free, creative, and determined by the youth's and family's needs.

All persons are treated equitably and without favoritism, subject to limitations imposed by contractual obligations.

# Transitional Family Homes Program



## HALE KIPA

91-2128 Old Fort Weaver Road • 'Ewa Beach, HI 96706  
 T 808.589.1829 • F 808.589.2610  
 info@halekipa.org • www.halekipa.org



Aloha United Way  
 Kauai United Way  
 Hawaii Island United Way



## HALE KIPA

Empowering Lives - One Youth At A Time



## CONSISTENCY, SAFETY & SUPPORT

### Transitional Family Homes (TFH)

Hale Kipa's Transitional Family Homes Program provides healthy therapeutic environments for youth with higher behavioral, physical, or emotional needs.

Upon completing treatment, the goal is to reunify children with their natural or identified family, whenever possible. Otherwise, TFH can teach youth skills needed to live independently.

Hale Kipa works to match foster youth, ages 3-17, with the right TFH. Placements are short-term, typically 3-6 months, at times longer. Families may decide to provide shorter-term respite care (1-14 nights) on an as needed or emergency basis.

## HALE KIPA RESOURCE CAREGIVERS

Make a lifelong impact in a child's life! Hale Kipa resources caregivers also receive additional benefits, not limited to:

- 24/7 on-call staff support
- Routine therapeutic and support services for youth
- Dedicated staff members
- Initial and ongoing training
- Monthly individual and group support
- Respite care
- Generous stipend

## ENVIRONMENTS TO THRIVE

Working to offer the best experiences for both caregivers and youth, Hale Kipa seeks homes that are:

- Family-oriented
- Flexible
- Organized
- Motivated to care
- Loving
- Nurturing
- Able to provide stability & structure

## Contact Information

Sidney Birmele-Frei  
Transitional Family Home Developer  
808.589.1829 Ext. 115  
sbirmelefrei@halekipa.org



*"I gave being vulnerable a chance because I felt safe in the foster home."*

*Makana*

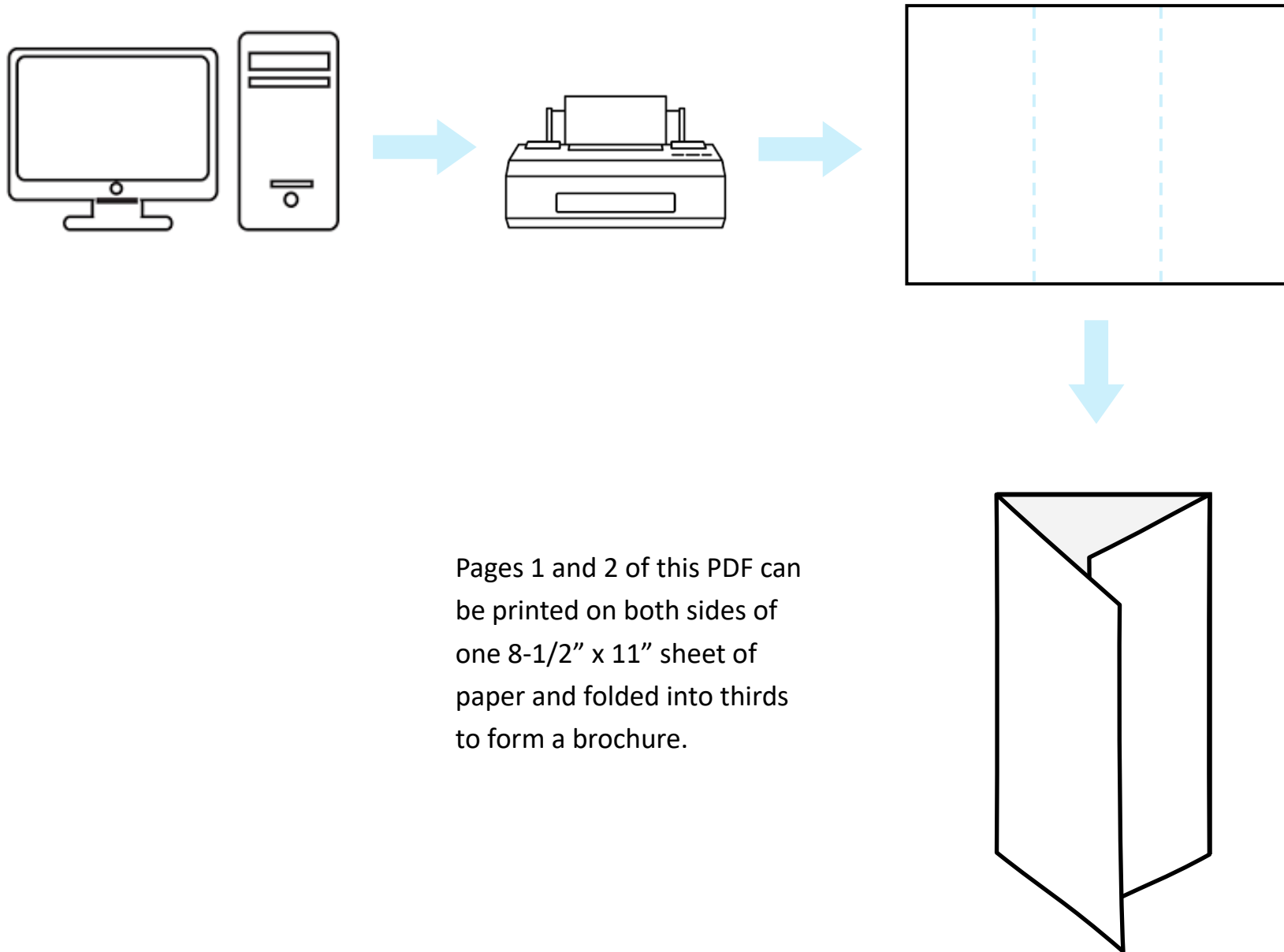

Pages 1 and 2 of this PDF can be printed on both sides of one 8-1/2" x 11" sheet of paper and folded into thirds to form a brochure.